



VNM SIMULATION., JSC

VNM DIRECT DRIVE USER MANUAL

REVISION 1.0

Contents

1. VNM Direct Drive Wheelbase specifications	2
2. Wheelbase Mounting Pattern	3
2.1. Front mounting pattern	3
2.2. Side mounting pattern	4
2.3. Bottom mounting pattern	5
3. Connection	9
4. Product safety warnings and instructions	10
4.1. Intended Use and User Responsibility	10
4.2. Torque and Control	10
4.3. Damage and Contact	10
4.4. Indoor Use and Environmental Conditions	10
4.5. Power Supply and Connection	10
4.6. Device Handling and Safety	10
4.7. Usage Recommendations	11
5. Safe Operation instruction	11
5.1. Read the User Manual	11
5.2. Secure Installation	11
5.3. Before Powering On	11
5.4. Power On	11
5.5. Safety Precautions	11

Please read the manual carefully before installing or operating the wheelbases.

1. VNM Direct Drive Wheelbase specifications

VNM Direct Drive Wheelbase Family (abbreviated as: “wheelbase”) has 4 types which have different specifications as bellow

	Premier	Elite	Supreme	Xtreme
SKU	VNM-DD01PRE	VNM-DD01ELI	VNM-DD01SUP	VNM-DD01XTR
Motor	5 polepairs smooth motor	5 polepairs smooth motor	5 polepairs smooth motor	5 polepairs smooth motor
Encoder	23-bit encoder	23-bit encoder	23-bit encoder	23-bit encoder
Maximum torque	13Nm	18Nm	25Nm	32Nm
VNM QR Base Side	Included	Included	Included	Included
EMC Stop Button	Regular (Superior optional)	Regular (Superior optional)	Superior	Superior
Power supply	300 W	360 W	480w	480w
Wheelbase Dimensions (without QR base side)	130x130x228mm	130x130x247mm	130x130x267mm	130x130x271 mm
Wheelbase weight (kg)	11.6	13.3	15.7	16
Packing Box(cm)	47x35x24	47x35x24	49x35x24	49x35x24
Box includes	<ul style="list-style-type: none"> - Wheelbase - Power Supply - USB A to B cable - USB A to C cable - EMC Stop Button - VNM Quick Release Base Side 			

	<ul style="list-style-type: none"> - 4xM8 bolts - A hex wrench set
--	--

2. Wheelbase Mounting Pattern

2.1. Front mounting pattern

All wheelbase of VNM has same front mounting pattern as following:

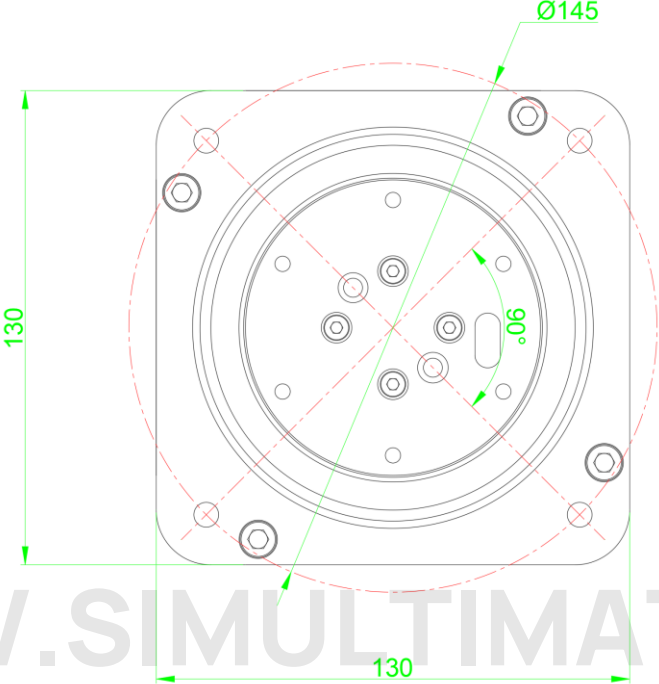

Figure 1. VNM Wheelbase Front dimensions

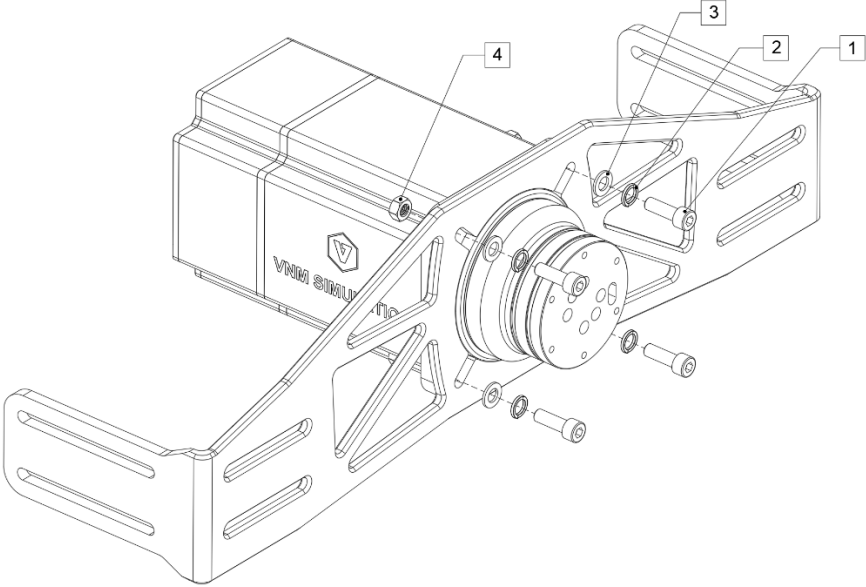

Figure 2. Mounting VNM Wheelbase on a simulator rig front mount bracket.

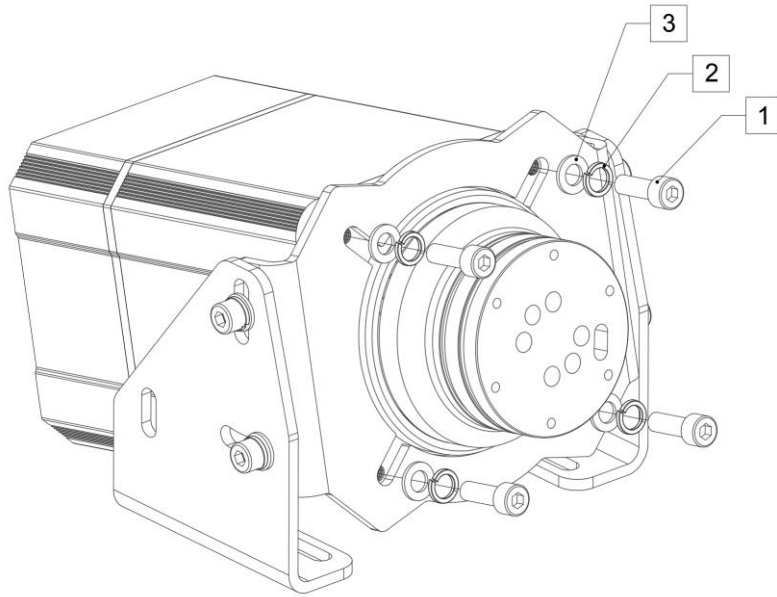

Figure 3. Mounting VNM Wheelbase using a mounting bracket

Wheelbase Xtreme	is mounted with 4xM8 bolts length 30mm with 1,25mm thread pitch (1); 4xM8 spring washers (2); 4xM8 flat washers (3) and 4xM8 nuts (4) in Figure 2
Wheelbase Premier, Elite, Supreme	are mounted with 4xM8 bolts length 25mm with 1,25mm thread pitch (1); 4xM8 spring washers (2) and 4 xM8 flat washers (3) in Figure 3.

2.2. Side mounting pattern

Only The wheelbase Premier, Elite, Supreme have side mounting pattern

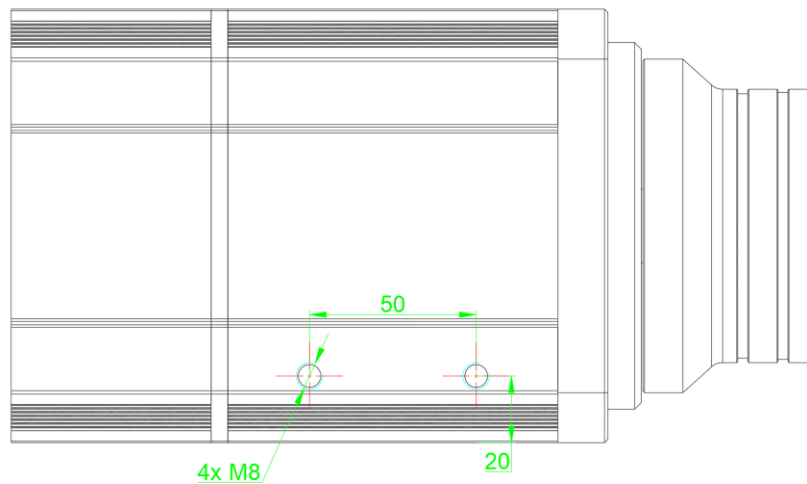

Figure 4. VNM Wheelbase Premier, Elite, Supreme side mounting pattern

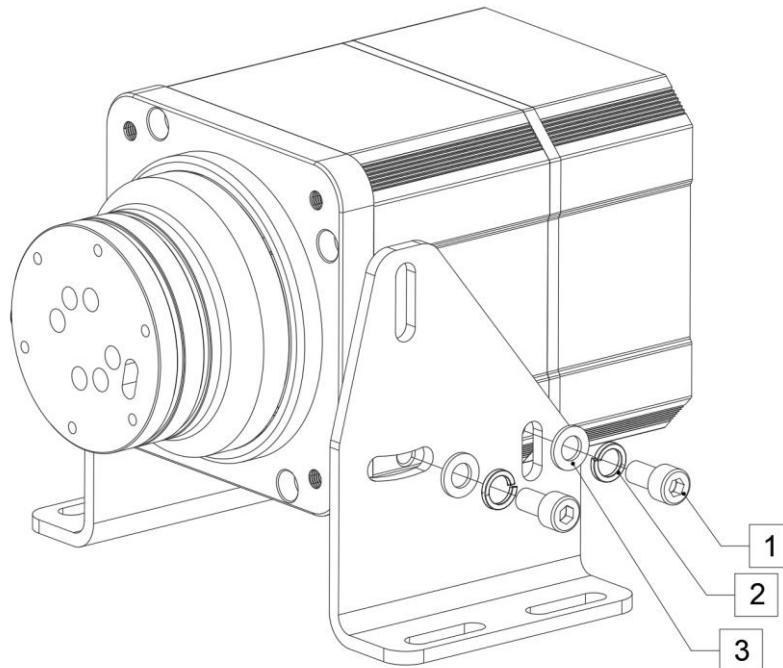

Figure 5. Mount VNM Wheelbase Premier, Elite, Supreme with side mount bracket. Wheelbase Premier, Elite. Supreme are mounted with 4xM8 bolts length 20mm with 1,25mm thread pitch (1); 4xM8 spring washers (2) and 4xM8 flat washers (3).

2.3. Bottom mounting pattern

Only The wheelbase Premier, Elite, Supreme have bottom mounting pattern

2.3.1. The Wheelbase Premier

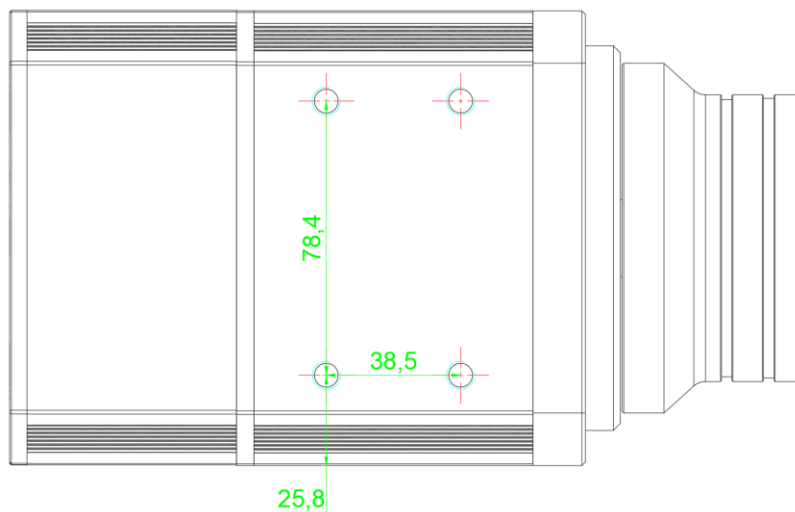

Figure 6. VNM Wheelbase Premier mounting pattern.

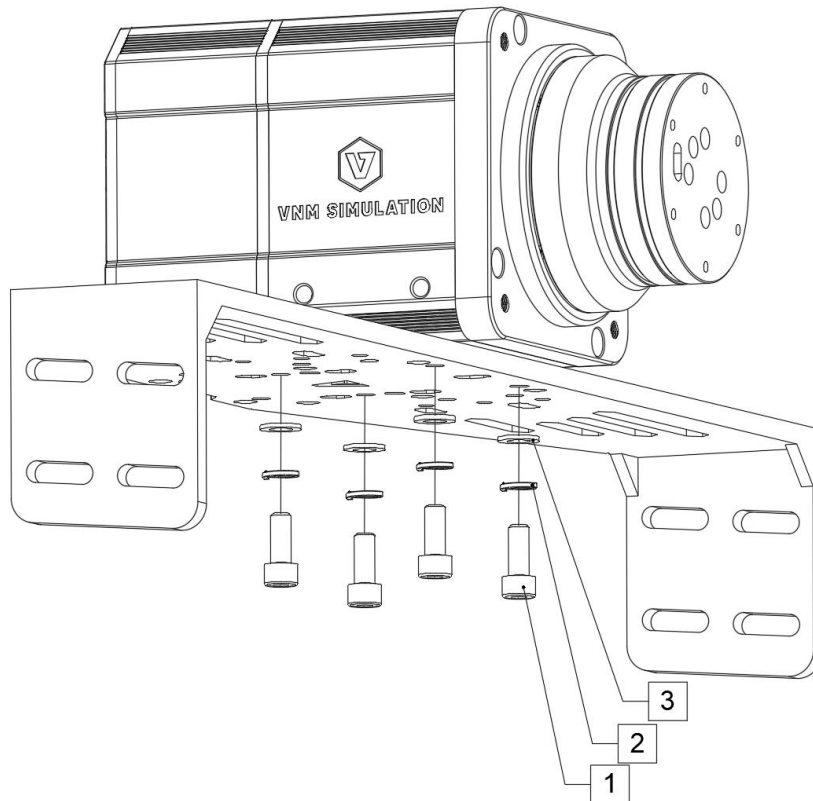

Figure 7. Mounting VNM Wheelbase Premier on bottom mounting bracket.

Wheelbase Premier is mounted with 4 x M8 bolts length 20mm with 1,25mm thread pitch (1); 4 x M8 spring washers (2) and 4 x M8 flat washers (3).

2.3.2. The Wheelbase Elite

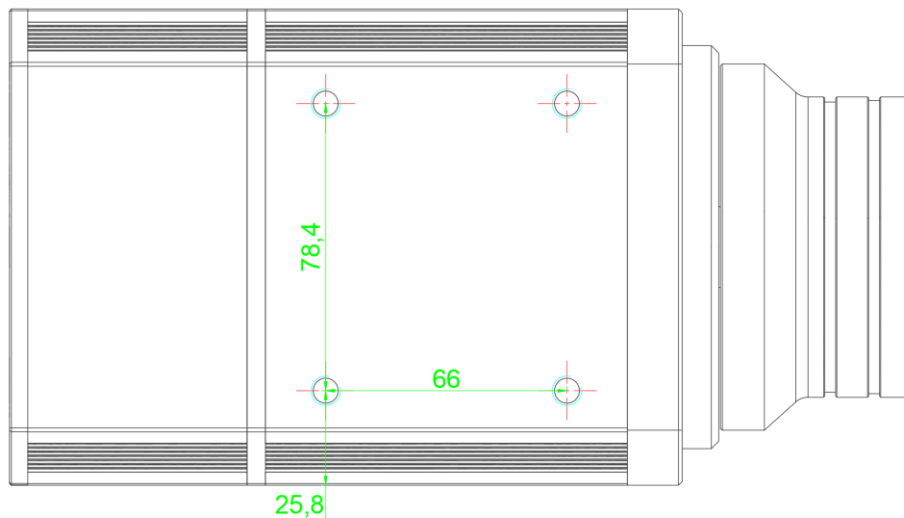

Figure 8. VNM Wheelbase Elite bottom mounting pattern.

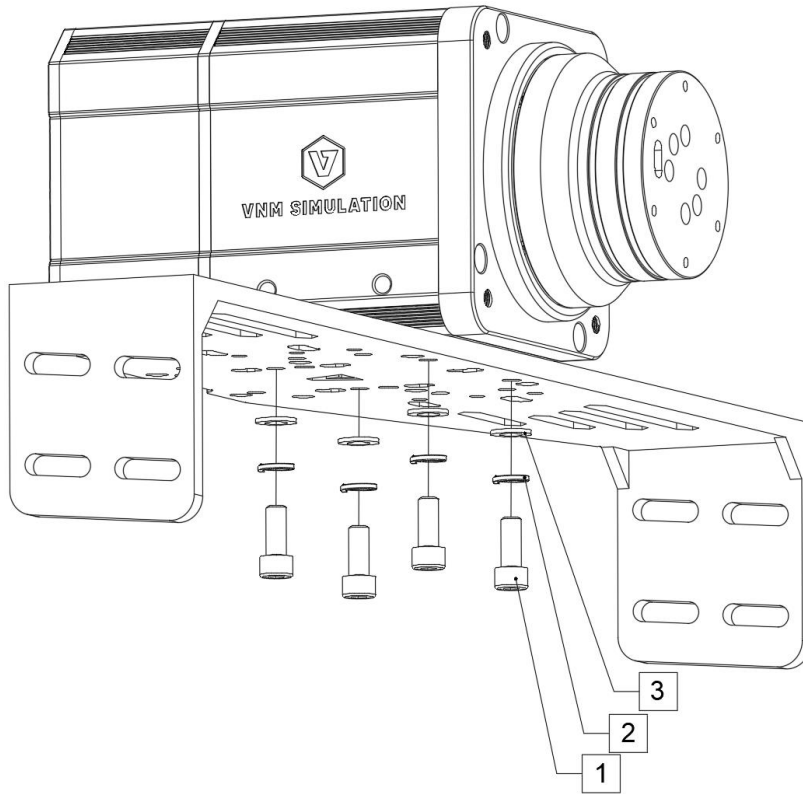

Figure 9. Mounting VNM Wheelbase Elite on bottom mounting bracket.
 Wheelbase Elite is mounted with 4xM8 bolts length 20mm with 1,25mm thread pitch (1); 4xM8 spring washers (2) and 4xM8 flat washers (3).

2.3.3. The Wheelbase Supreme

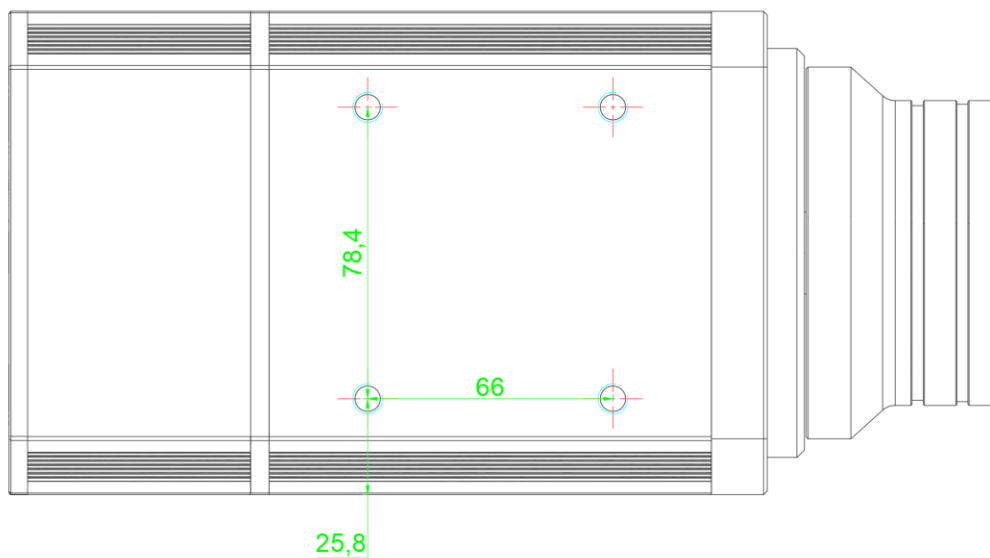

Figure 10. VNM Wheelbase Supreme bottom dimensions

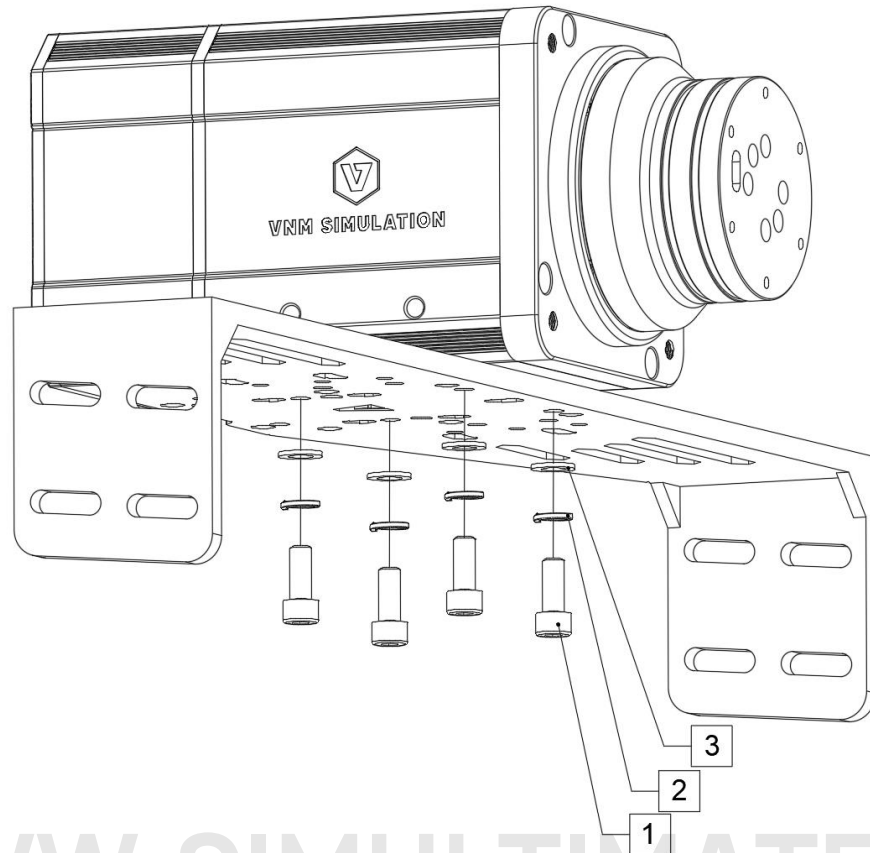

Figure 11. Mounting VNM Wheelbase Supreme on bottom mounting bracket.

Wheelbase Supreme is mounted with 4xM8 bolts length 20mm with 1,25mm thread pitch (1); 4xM8 spring washers (2) and 4xM8 flat washers (3).

3. Connection

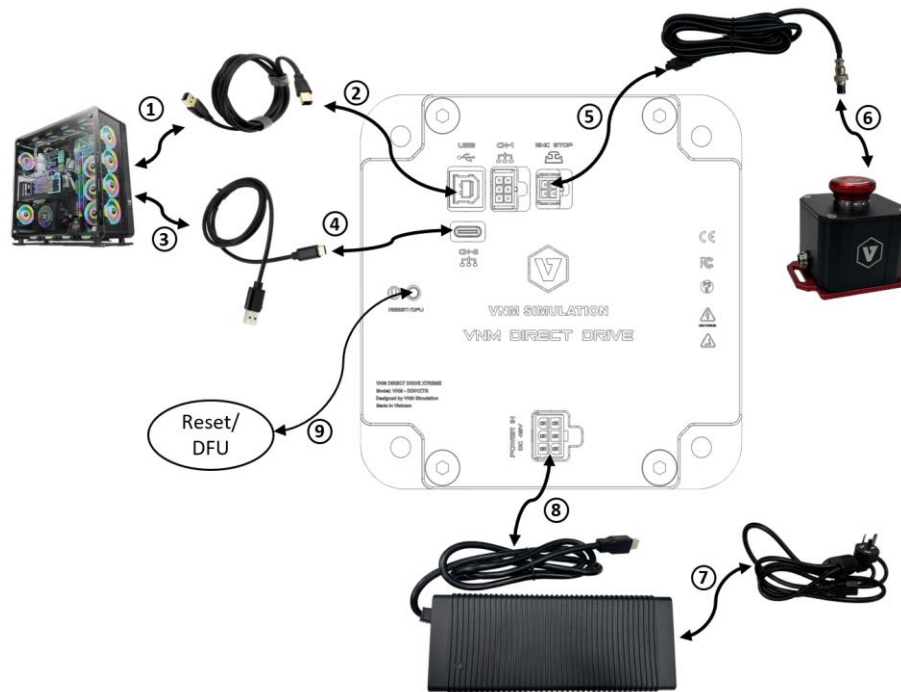

Figure 12. Connection ports of VNM Wheelbase.

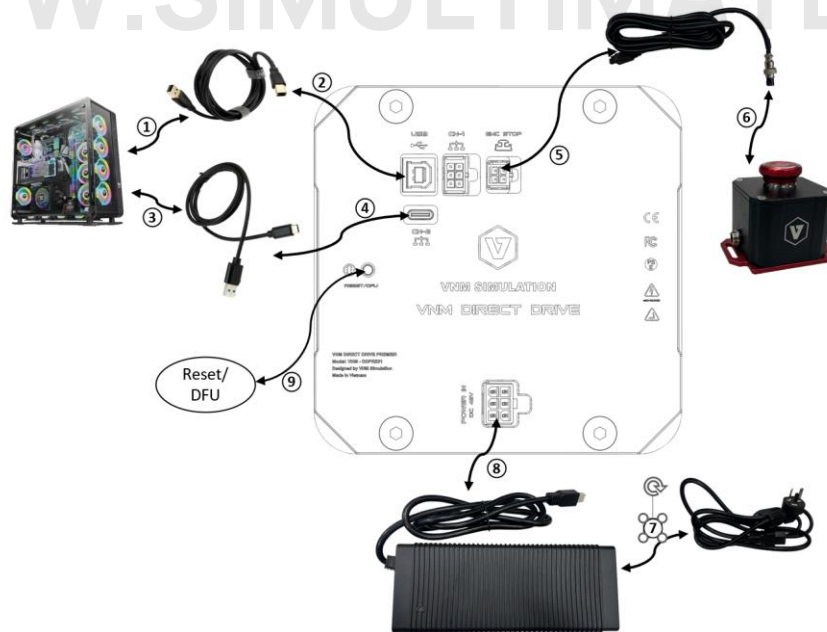

Figure 13. Connection ports of VNM Wheelbase Supreme

Wheelbase Premier, Lite uses a normal EMC Stop Button, and lower power adapters which has different appearance and the connection are same with the wheelbase Supreme.

CN-4 is used for future use.

Disclaimer:

Please note that the appearance of VNM wheelbases may vary from the illustrations in this User Manual and from the product images on the VNM Simulation website (<https://vnmsimulation.com>)

4. Product safety warnings and instructions

4.1. Intended Use and User Responsibility

- The Wheelbase Supreme and Xtreme are designed for professional use only. Any other usage is at the user's own risk.
- These wheelbases are intended for use by adults who are in good physical and mental health.

4.2. Torque and Control

- The wheelbases can generate high torque up to 32Nm.
- Do not set the torque level higher than what can be safely managed with one hand.
- If the torque becomes uncontrollable, release the steering wheel and press the EMC stop button.

4.3. Damage and Contact

- If the wheelbase shows any signs of damage, discontinue use immediately and contact the seller or VNM Simulation.

4.4. Indoor Use and Environmental Conditions

- These wheelbases are intended for indoor use only.
- Avoid exposing the wheelbases to heat sources or direct sunlight.
- Do not place the wheelbases in damp environments or in contact with water.
- Recommended operating temperature: 10-35 degrees Celsius.

4.5. Power Supply and Connection

- Unplug the power cord during thunderstorms or when the wheelbase will not be used for extended periods.
- Always connect the DC side of the power supply to the wheelbase before connecting the AC side to the power outlet.
- Only use the power supply and power cord provided with the wheelbase or obtained from an authorized reseller.

4.6. Device Handling and Safety

- Do not open the casing of the wheelbase.

- Handle the power supply with care to avoid damage.
- The wheelbase contains magnets that may interfere with electronic devices. Keep such devices at least 20cm away.

4.7. Usage Recommendations

- It is recommended to use the wheelbases for no more than 2 hours per day, with breaks after every hour. Excessive use of force feedback may be harmful to your health.
- The surface temperature of the wheelbase can reach up to 70 degrees Celsius (158°F). Do not touch the wheelbase surface during operation or within 2 hours after use.

5. Safe Operation instruction

5.1. Read the User Manual

Carefully read the user manual before installing or operating the wheelbases.

5.2. Secure Installation

- Securely mount the wheelbases on a rigid platform, such as a sim racing rig, using the specified mounting pattern in section 2.
- Never operate the wheelbases without securing them to a rigid platform. Other types of fixings are not allowed.
- Firmly install the EMC Stop button on the rigid platform in a position where it can be easily pressed.

5.3. Before Powering On

- Download and open the VNM Config software from VNM Simulation to see operating status of the wheelbases.
- Attach a steering wheel firmly using the VNM quick release set (not included with the wheelbase).
- Ensure that children under 15 years old are kept away from the wheelbases.
- Keep all loose objects, such as hair, clothing, and cables, away from the wheelbases.
- Use a USB type B to type A cable to connect the wheelbases to the computer.
- Connect the DC side of the power supply to the wheelbase.

5.4. Power On

- Only plug the power supply into a 110-240 V AC outlet with protective earth after completing all the above steps.
- Test the function of the EMC stop before each usage session.

5.5. Safety Precautions

- Do not touch the freely rotating steering wheel directly or indirectly.

- Always use the EMC stop button to stop and prevent motion.
- Children under 15 years old are not allowed to use the Premier or Elite wheelbase in high torque mode, and any mode of the Supreme and Xtreme wheelbase.
- After each use, press the EMC stop button or unplug the power supply.
- Always press the EMC stop button before removing or attaching a steering wheel to the wheelbases.
- Always use the EMC stop button to stop and prevent motion.
- Children under 15 years old are not allowed to use the Premier or Elite wheelbase in high torque mode, and any mode of the Supreme and Xtreme wheelbase.
- After each use, press the EMC stop button.
- Always press the EMC stop button before removing or attaching a steering wheel to the wheelbases.
- Do not release the EMC button unless the VNM Quick release handle is closed and the VNM Quick release is secure.
- Inform other users of the safe usage of the wheelbases before use.

WWW.SIMULTIMATE.EU