

VNM LITE PEDAL

Quick Guide

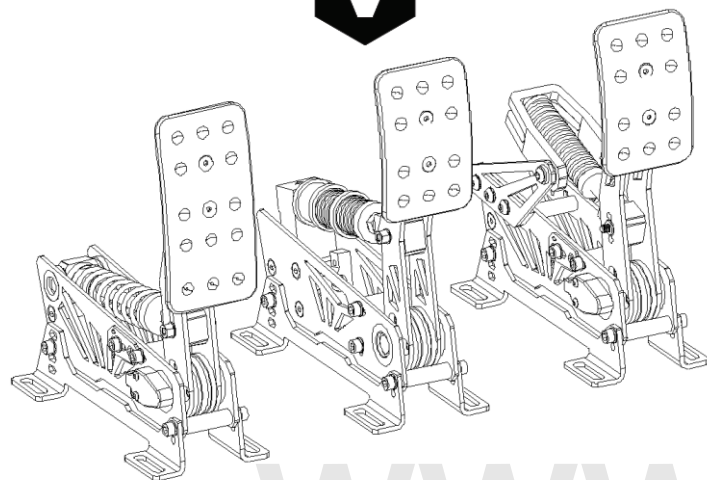

Content

1. VNM Throttle
2. VNM Brake
3. VNM Clutch
4. Pedal Controller Box
5. USB Cable type C
6. Allen key set & Mounting screws
7. 02 black, 01 yellow spring, and 01 elastomer

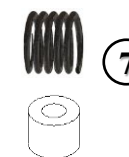
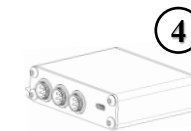
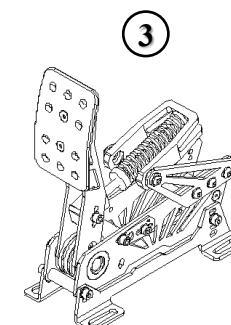
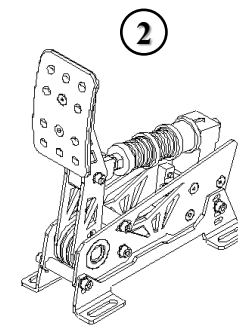
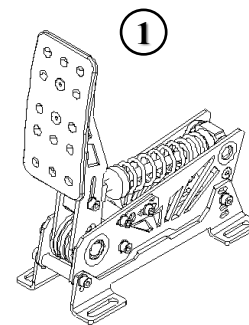

Connection

✓ On the right side of the VNM Controller Box:

1. Plug in USB cable to connect to PC.
2. Throttle
3. Brake
4. Clutch
(Plug in the GX12 ports for signal connection)

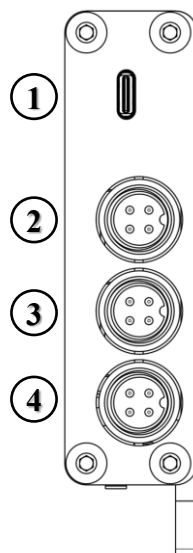

✓ On the bottom side of the VNM Controller Box is:

5. Switch **DFU/Game Mode**
Slide left side to select **DFU Mode** or right side to select **Game Mode**.

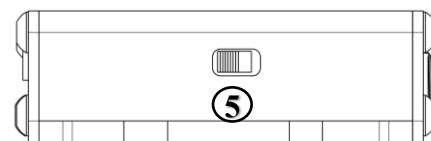

✓ On the left side of the VNM Controller Box is:

6. Plug in RS-485 port
7. Plug in for VNM haptic 1
8. Plug in for VNM haptic 2
9. Plug in for VNM haptic 3
10. Plug in for DC 24V power
(using with VNM haptic)

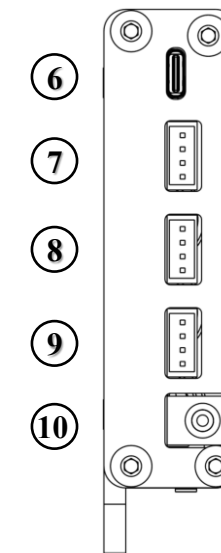

WWW.SIMULTIMATE.EU

Adjust Pedal

1. Adjust the height of the Pedal face

- ✓ Loosen the 4 the hex bolts on the sides behind the pedal face, choose a suitable pedal height, then tighten.

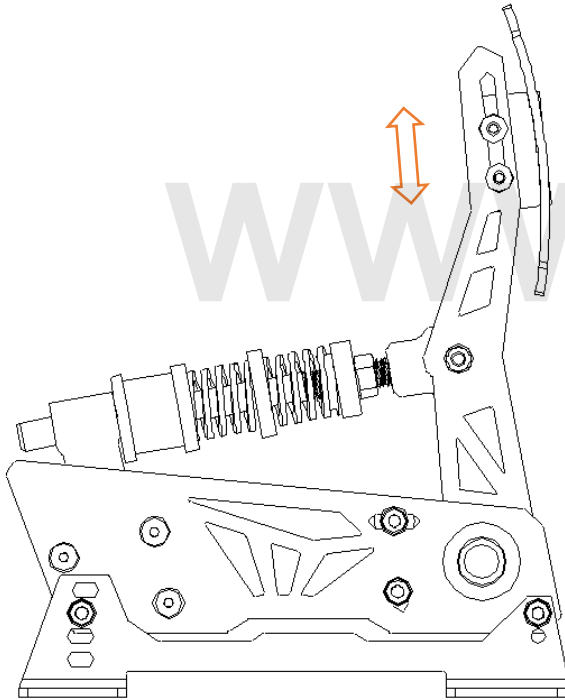

2. Adjust the Pedal tilt angle

- ✓ Here we give 6 options so you can change the angle of the pedal to your liking.
- ✓ Remove the hex bolts on the sides, then choose the angle that suits you and tighten them with the hex bolts.

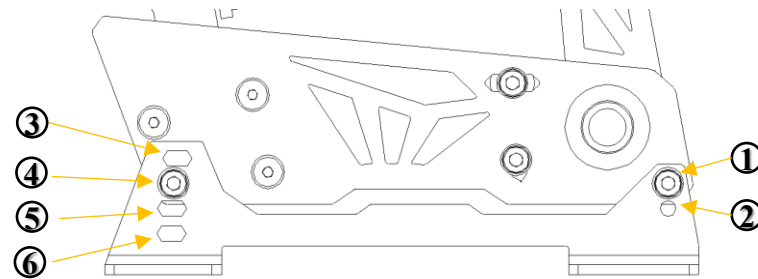

3. Adjust the Pedal Force

- ✓ Adjust the spring preload so that the pedal force is right for your foot

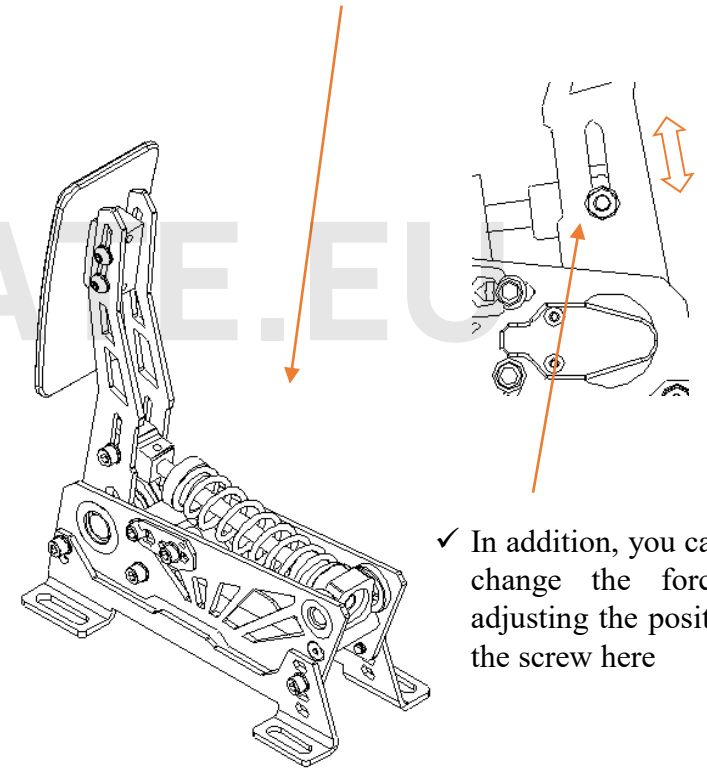

- ✓ In addition, you can also change the force by adjusting the position of the screw here

4. Adjust the Pedal Journeys

- ✓ Loosen the 2 hex bolts on the sides, adjust 2 blue bumpstops to change pedal stroke

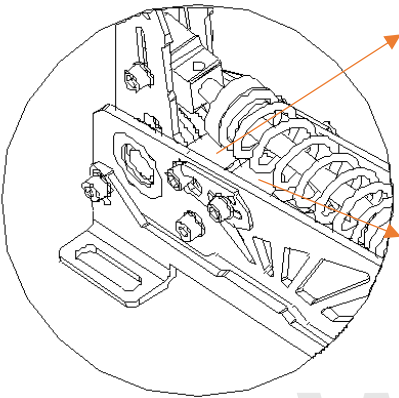

- Blue Bumpstop 1:** Move blue bumpstop to change pedal stroke limit.
- Blue Bumpstop 2:** Adjust the inclination of the pedal face (pedal stroke start point)

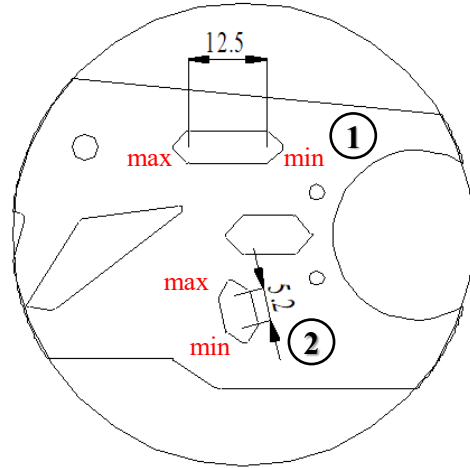

- ✓ Adjusting the Blue Bumpstop 1

Step 1: Remove spring assembly.

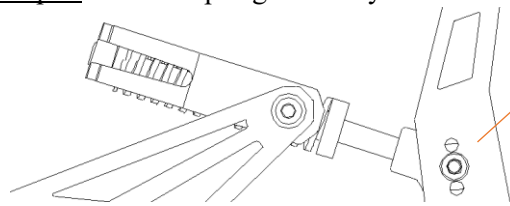

Remove bolts then
remove spring assembly

Step 2: Loosen the hex bolts 1 & 2 on the sides then choose the location of the blue bumpstop that works for you and tighten the hex bolts 2 you just loosened.

Step 3: Move the locating pin to fix the hex bolt 2 then tighten the hex bolt 1 (with VNM Throttle and VNM Clutch).

Step 4: Reinstall the spring assembly.

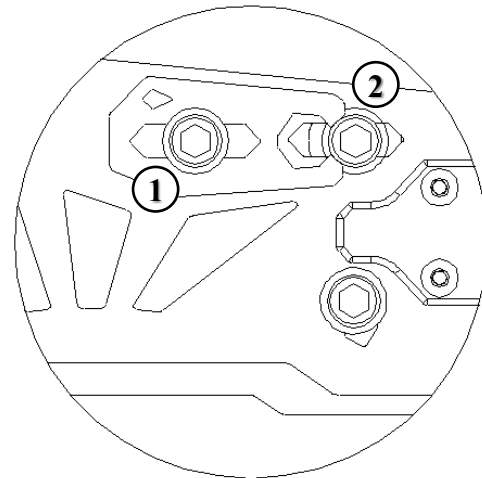

5. Exchange Spring & Elastomer

Step 1: Remove the elastomer stack

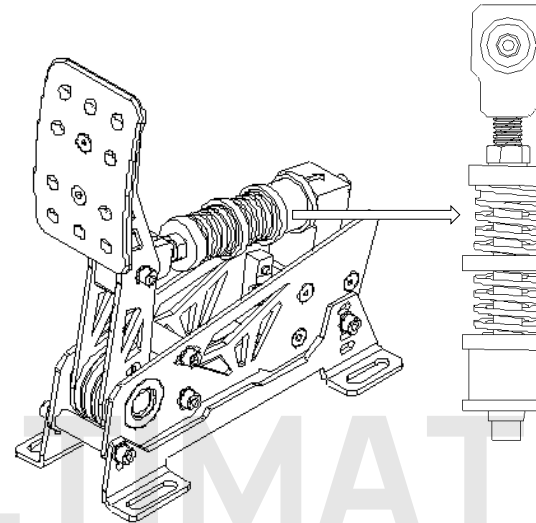

Step 2: Choose a suitable combination of springs and elastomers

3 combinations are recommended, but feel free to mix and match to find the perfect combo for you.

Option 1: Red, Blu, Yellow spring + 2 elastomers

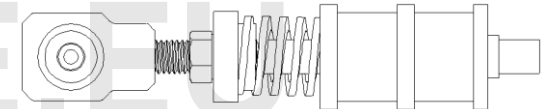

Option 2: Steel spring + 2 elastomers

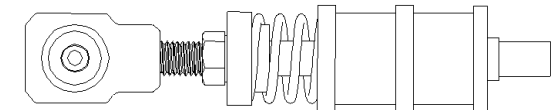

Option 3: 2 springs + 1 elastomer

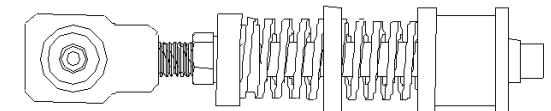

Step 3: Re-install the elastomer stack

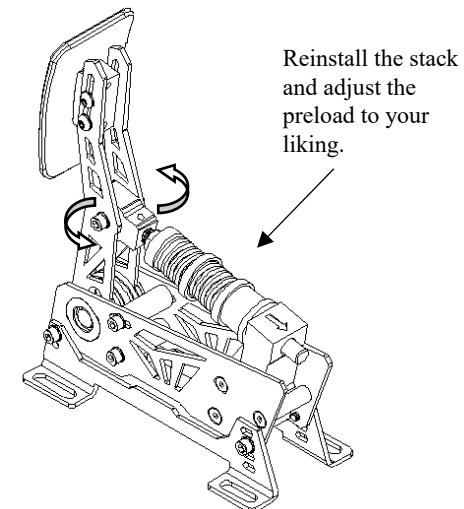

Reinstall the stack
and adjust the
preload to your
liking.

Mounting Dimention Throttle

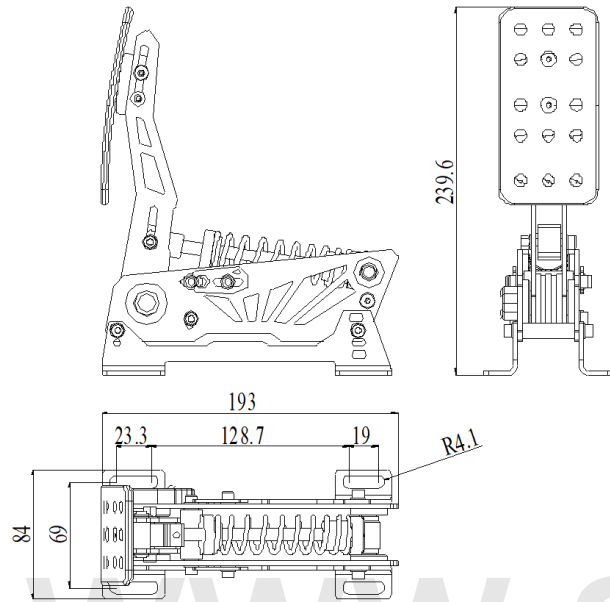

Mounting Dimention Brake

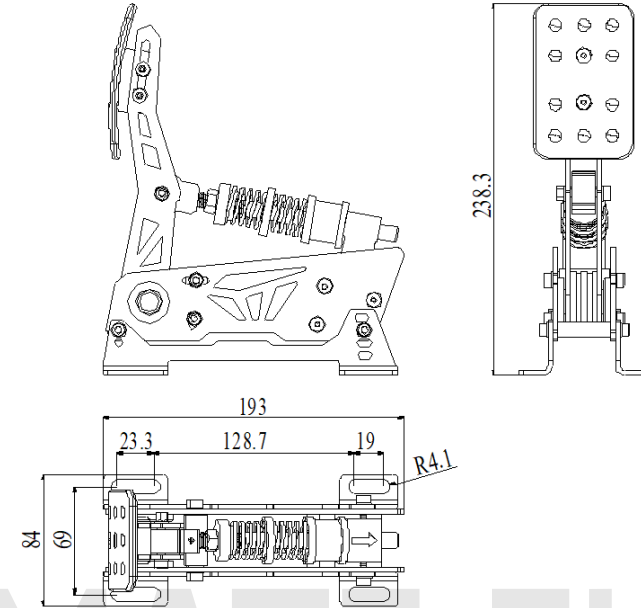

Mounting Dimention Controller Box

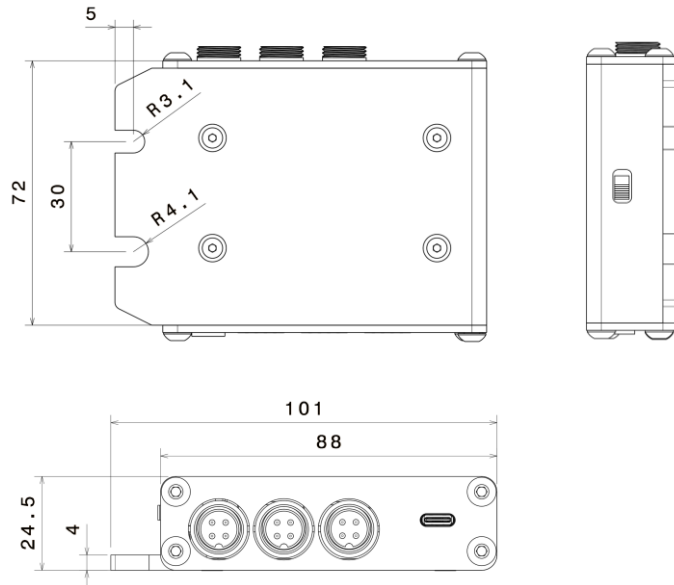

Mounting Dimention Clutch

